



BRD Builders
Powered by RedTeam

OUR CHANGE PROPOSAL

03/28/2024

Christopher Nardi
Town Of Colchester
127 Norwich Ave
Colchester, CT 06415

Re: PCO 35 for **Regrade Patio per SK 15**

Project: Colchester Senior Center

Colchester Senior Center, 15 Louis Ln, Colchester, CT 06415

This Proposal is for the Change referenced above and more particularly defined by the Scope of Work comprised of this Proposal, its Attachments, and other Contract Documents incorporated by reference. Therefore, we propose to change the following:

2 - Site Work

1. Additional Fill Needed
2. Spread and Compact Fill
3. GML O+P 10%

Price: \$ **816.64** *Eight Hundred Sixteen Dollars and Sixty Four Cents*

Time: The duration of the Work to achieve Substantial Completion will be **UNCHANGED**.

Clarification(s): - All work per SK-15 provided by SLR to raise patio and reduce pitch

Expiration: This Proposal shall remain open for 30 calendar day(s).

Please contact me at (860) 706-0359 or via e-mail R.Lamarre@brdbuilders.com if you have any questions or require additional information.

Regards,
BRD Builders
Robert Lamarre

ACCEPTANCE OF PROPOSAL

The Scope of Work described above supersedes any and all prior communication about this Change.

Customer Signature: _____ Date: _____

Town Of Colchester



BRD Builders
Powered by RedTeam

COST ESTIMATE
Including Item Details

1800001 - 35 - Regrade Patio per SK 15

Manager: Robert Lamarre

As of 3/28/2024

Authorized Change 35

Phase	Description	Quantity	U/M	Labor (\$)	Material (\$)	Subcontract (\$)	Equipment (\$)	Other (\$)	Total (\$)
-	02000								
	GML Construction	1.00	l/s	0.00	0.00	710.12	0.00	0.00	710.12
	Supervisor	2.00	hrs	Subcontract @	94.63	=			189.26
	<i>SITE WORK</i>								
	Additional Fill Needed	18.00	cy	Subcontract @	15.00	=			270.00
	Spread and Compact Fill	18.00	cy	Subcontract @	10.35	=			186.30
	GML O+P 10%	1.00	l/s	Subcontract @	64.56	=			64.56

SUBTOTAL DIRECT COSTS	0.00	0.00	710.12	0.00	0.00	710.12
Indirect Costs	0.00	0.00	0.00	0.00	0.00	0.00
Indirect Cost Allocation Rates	0.00%	0.00%	0.00%	0.00%	0.00%	0.00%
TOTAL DIRECT & INDIRECT COSTS	0.00	0.00	710.12	0.00	0.00	710.12
Profit Margin					13.04%	106.52

Supplemental Markups:

TOTAL PRICE	816.64
--------------------	---------------

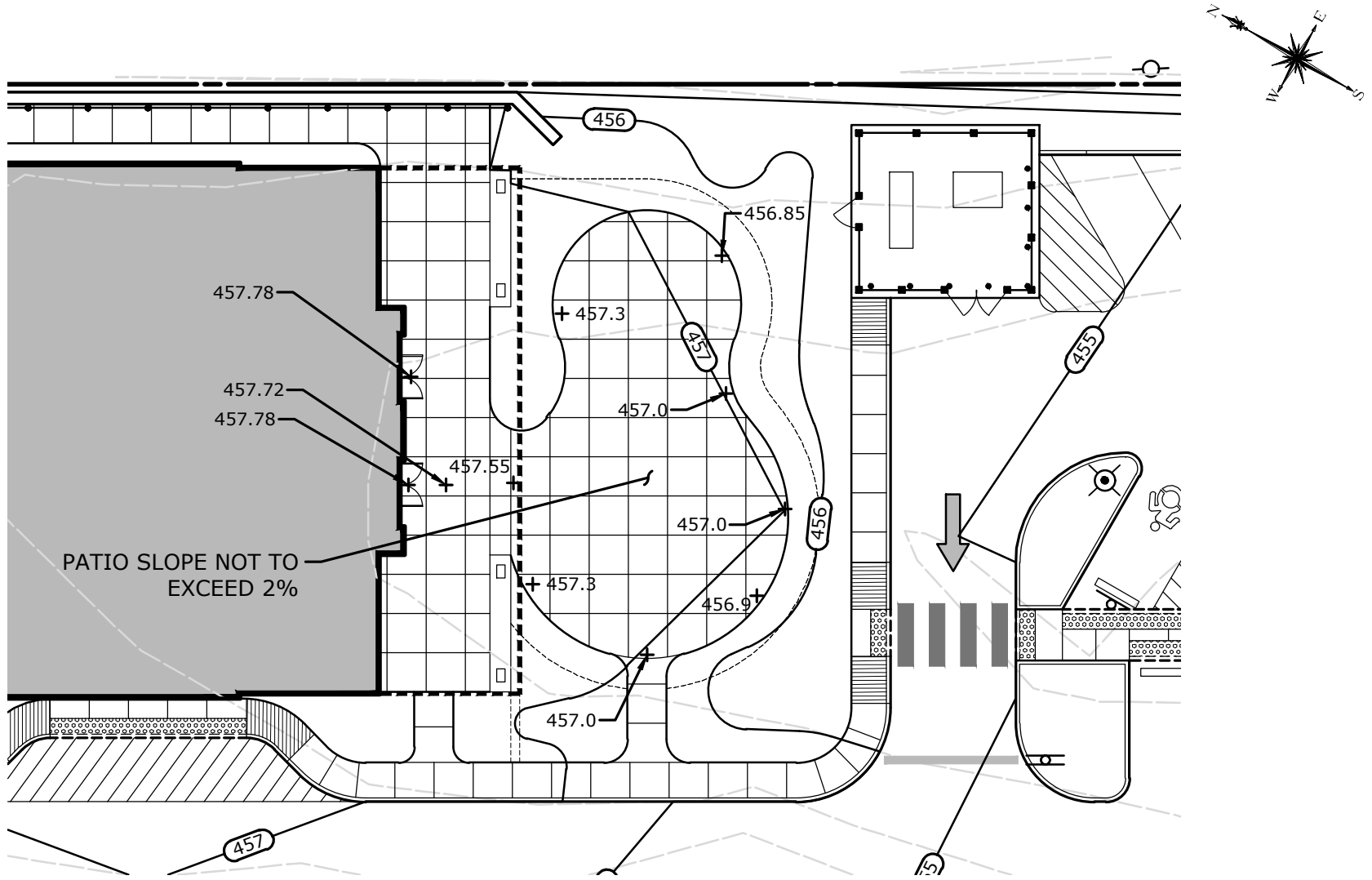

NOTE:
 THIS SKETCH IS ISSUED IN RESPONSE TO A DISCUSSION THAT OCCURRED IN OUR VIRTUAL MEETING WITH BRD AND THE DESIGN TEAM ON 3/20/24.



99 REALTY DRIVE
 CHESHIRE, CT 06410
 203.271.1773
 SLRCONSULTING.COM

DATE	MARCH 21, 2024
SCALE	1"=20'
PROJ. NO.	3373-108
DESIGNED	JJM
DRAWN	JJM
CHECKED	DWD

SKETCH- PATIO GRADING
COLCHESTER SENIOR CENTER
 15 LOUIS LANE
 COLCHESTER, CONNECTICUT

PROJECT PHASE:
FOR CONSTRUCTION
 DRAWING NAME:
SK-15

GML
BRD Colchester

3/28/2024

PCO for: Regrade Patio Area Per SK-15

Change Order Worksheet				
Description	Unit	Quantity	Unit Price	Extended Price
Regrade patio per SK-15				
Adjust 3D model for layout:				
Supervisor	Hr	2	\$94.63	\$189.26
Additional fill	CY	18	\$15.00	\$270.00
Spread & compact fill	CY	18	\$10.35	\$186.30
O&P 10%				\$64.56
TOTAL:				\$710.12