

## ANTICIPATED CONSTRUCTION PHASING

- Clear and grub the proposed parking lot area by removing and disposing off-site of all existing trees, brush and stumps within the limits of proposed disturbance.
- Install construction entrance/anti-tracking pad and silt fence.
- Remove topsoil/leaf litter and stockpile for use around perimeter of parking lot.
- Regrade existing subgrade to establish proposed grading pattern shown on plan and ultimately form the compacted subgrade to receive the controlled gravel subbase and base of the parking lot area.
- Install the 8" thick compacted layer of bank run gravel meeting the M.02.06 gradation B specifications of the State DOT.
- Install the 4" thick compacted layer of processed gravel meeting the M.05.01 specifications of the State DOT.
- Install the 2" layer of 3/4" crushed stone surface over parking lot area and the 3" thick compacted layer of Bituminous concrete over the paved apron area of the driveway.
- Utilize on-site material to establish slope grading along perimeter of parking lot and top with 4" layer of screened topsoil, perennial grass seed and straw mulch to establish a stable vegetative cover over all disturbed areas.
- Install line striping on paved bituminous concrete paved apron.
- Install all proposed signs.
- Install concrete wheel stops.

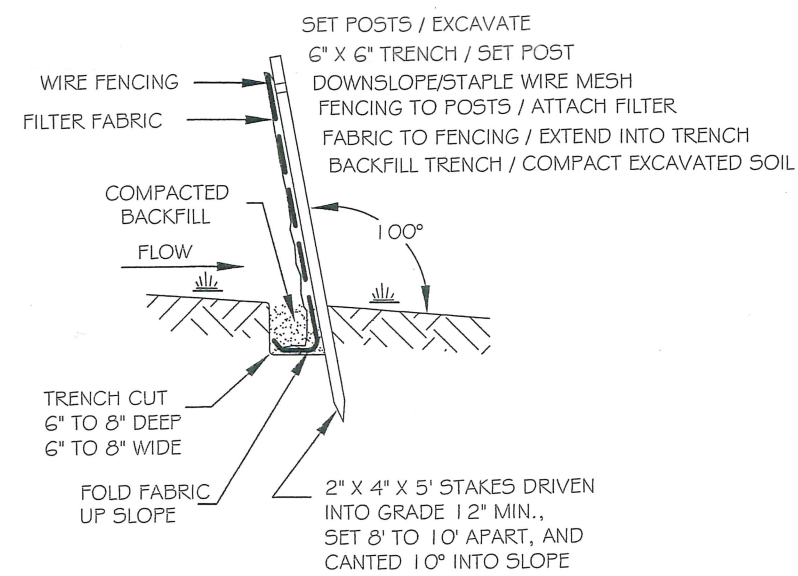

**SILT FENCE DETAIL**  
(NOT TO SCALE)

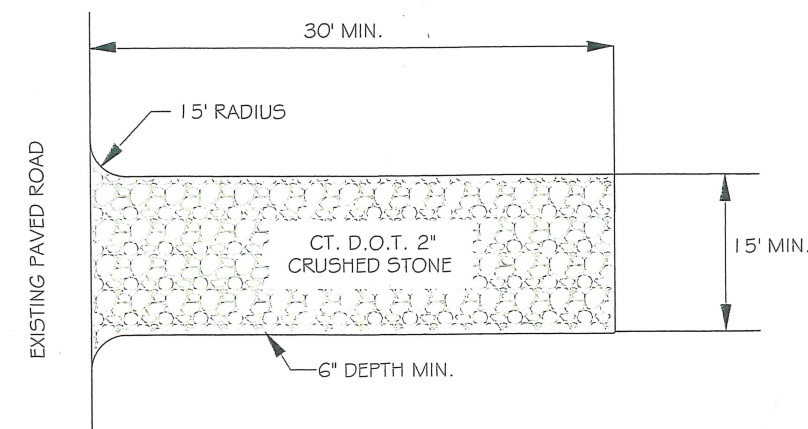

**ANTI - TRACKING PAD DETAIL**  
NOT TO SCALE

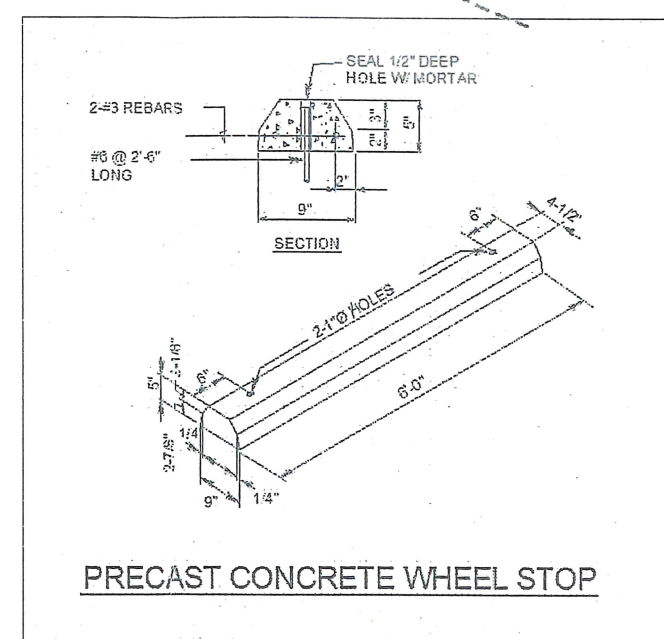

**PRECAST CONCRETE WHEEL STOP**

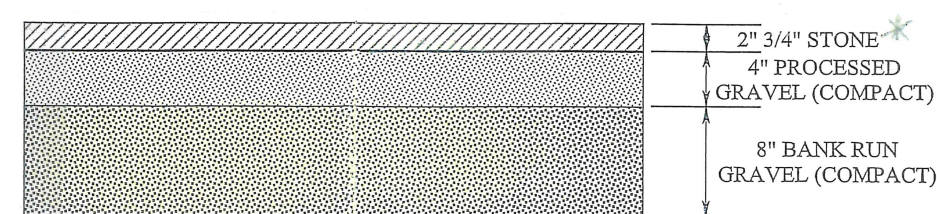

**GRAVEL PARKING AREA  
PROFILE DETAIL**

\* 3" thick compacted Bituminous concrete (1.5" class 2 over 1.5" class 1)  
Within area of proposed paved apron

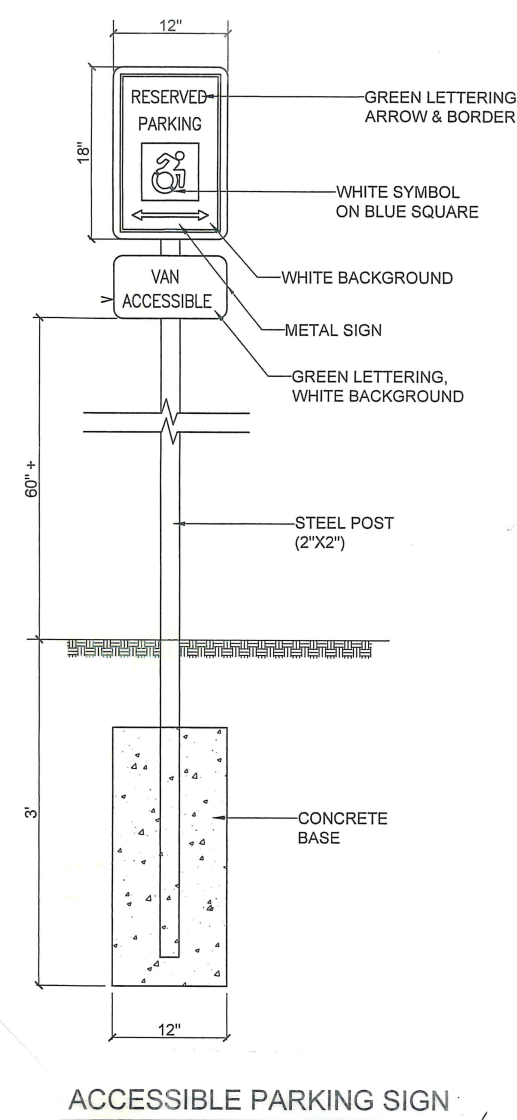

**ACCESSIBLE PARKING SIGN**

## GENERAL NOTES:

- Existing grades and property line information taken from Town GIS maps
- Culvert and CHD locations taken from State DOT Highway R.O.W. maps
- Call before you dig 1-800-922-4455** Existing utilities have been plotted from the best available sources. The locations are only approximate and there may be additional utilities within the project area. The contractor shall verify the locations of all existing utilities within the work area and notify each affected utility company prior to commencing construction.
- Work within the State of CT. DOT Right of Way for Middletown Road/Route 16 requires an encroachment permit. The Town has obtained the necessary encroachment permit from DOT district 2. **The contractor shall contact the DOT District 2 permits office to inform of proposed construction schedule prior to commencement of any construction activity.**
- All disturbed areas along perimeter of proposed Gravel parking areas and driveway shall be fine graded with minimum 4" topsoil, seeded and mulched to establish a stable vegetative surface area.
- Two trail head specific signs/posts will be supplied by the Town for installation by the contractor. One sign will be a kiosk style sign on a double post and the other will be a facility name sign on a single post. Installation by contractor will consist of excavation, installation of 12" diameter x 3 feet deep sonotube concrete piers, placement of posts within sonotube centers and backfill of sonotubes with concrete to properly secure and support the signs. Location of signs will be as directed by Town staff in the field.

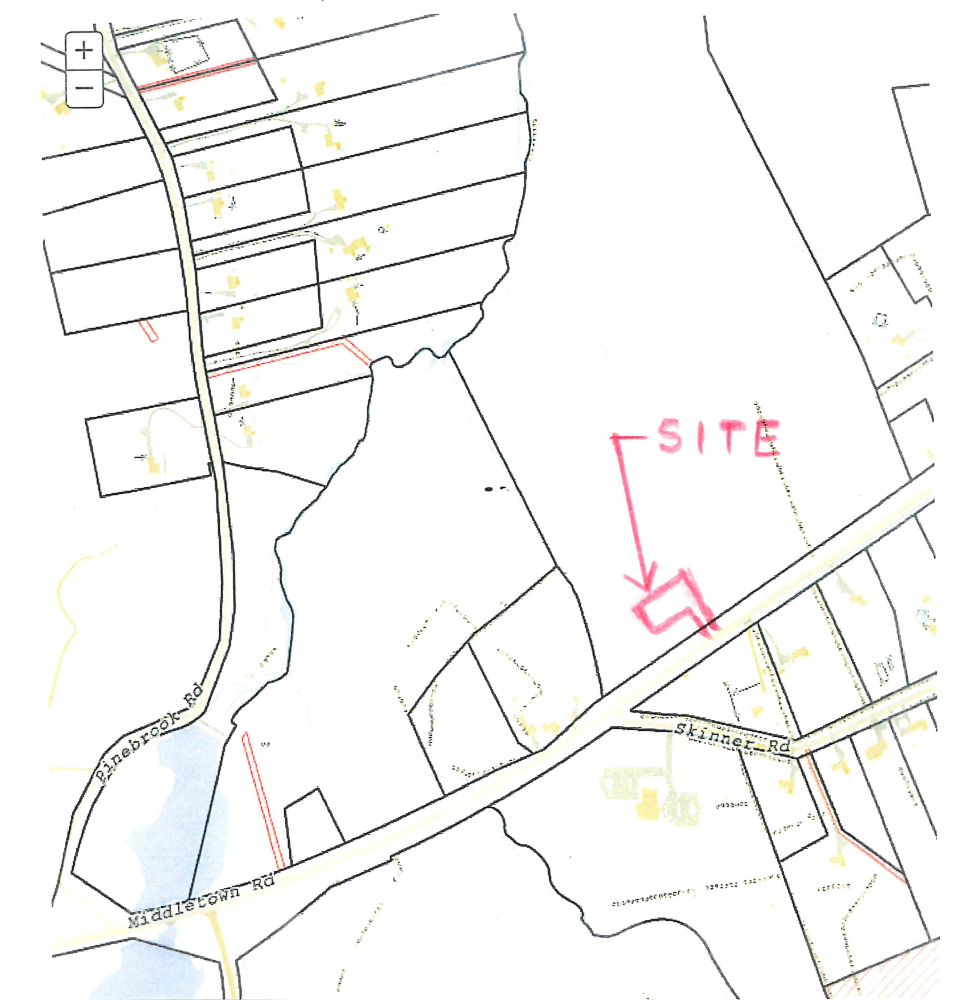

**LOCATION MAP (NTS)**



BENCH MARK (TOP OF CHD)  
ASSUME ELEV. = 479.5

PROPOSED TRAIL HEAD PARKING LOT  
MIDDLETOWN ROAD/RTE.16, COLCHESTER CT.  
(SABLITZ OPEN SPACE PROPERTY)  
PREPARED FOR TOWN OF COLCHESTER  
BY: SALVATORE TASSONE P.E. (TOWN ENGINEER)  
DATE: 3/24/2021, REVISED 12/21/2021, REVISED 4/24/23  
SCALE: 1"=20'